

Licensing Sub-Committee Report

Subject of hearing: **Papa John's, 413 Durnsford Rd, SW19 8EE.**

Date **28 February 2024**

Time: **11.00am**

Venue: **Virtual Meeting**

1. Special Policy Area (premises licences and club certificates)

The premises are not in the special policy area on cumulative impact.

2. Type of hearing and powers of the sub-committee

2.1 The sub-committee is required to determine the application by taking such of the steps set out below as it considers appropriate for the promotion of the licensing objectives.

2.2 In making their determination the sub-committee must have regard to the Licensing Act 2003, the licensing objectives, guidance issued by the Secretary of State and Merton's Licensing Policy.

2.3 New premises licence: s18

(i) To grant the licence subject to conditions

(ii) To exclude from the scope of the licence any of the licensable activities to which the application relates

(iii) To refuse to specify a person in the licence as the premises supervisor

(iv) To reject the application.

3. Hearing papers

3.1 The applications, notices and representations for determination by the sub-committee are contained in the hearing bundles together with any relevant existing licence. This includes any documents which must be sent to any of the parties to the hearing under Regulation 7(2) and Schedule 3 of The Licensing Act 2003 (Hearings) Regulations 2005. This bundle has been issued to all parties to the hearing.

4. Legal advice to the sub-committee

4.1 A legal officer appointed by the Assistant Director of Corporate Governance and Head of Legal Services will attend the hearing to advise the sub-committee on statutory provision and legal matters.

5. Licensing Officer comments

5.1 This is an application for a new premises licence, for a premises described in the application as a fast food store with delivery service.

5.2 The applicant originally applied for the provision of late night refreshment Monday to Sunday 23:00 to 05:00 the next morning, with an additional hour on the day when British summertime commences.

5.3 The opening hours are stated in the application as 24 hours Monday to Sunday.

- 5.4 On the 25 January 2024, after consultation between the Applicant and the Metropolitan Police, we received an email stating that the applicant had agreed to amend the application. The amendment is as follows:
- Late night refreshment hours reduced – Monday to Sunday 23:00 to 02:00 the following morning.
 - Hours open to the public hours reduced - Monday to Sunday 11:00 to 00:00
 - Deliveries only, times reduced - Monday to Sunday 00:00 to 02:00.
 - Four conditions were agreed. These conditions are included in an annex to this report.
- 5.5 The application sets out steps that the Applicant will take to promote the four licensing objectives. Conditions consistent with those steps could be attached to the licence should the Sub-Committee decide to grant the application, in addition to any additional conditions the Sub-Committee believe appropriate for the promotion of the Licensing Objectives. Conditions have been agreed with the Metropolitan Police that would re-write what was offered by the Applicant and we believe could be converted to conditions.
- 5.6 Twenty-one relevant representations regarding this application were received, all from local residents.
- 5.7 For ease, conditions agreed with the Metropolitan Police are included as an annex to this report. The Sub-Committee may choose to form some conditions on the licence from these should they decide to grant the licence.
- There has been a previous application for a premises licence at this address that was refused by the Sub-Committee in August 2020, but our records show this was from a different applicant.
- It must be remembered that each application should be considered on its own merits.

For enquiries about this hearing please contact

Democratic Services
Civic Centre
London Road
Morden
SM4 5DX

Telephone: 020 8545 3616

Email: democratic.services@merton.gov.uk

Parties to the hearing

This document forms part of the notice of hearing.

The following are parties to the hearing having submitted relevant applications, notices or representations under the statutory provisions indicated:

Applicant	
Papa John's	
Statutory Authorities	
Interested Parties	
Mimiko Hogwood	
Stanislas Hembise	
Viren Patel	
Roland Seregi	
Nick Tunnell	
James Dickerson	
Taliah Walklett	
Barbara Walters	
Xinya Guo and Robin Bangs	
Edward Gaffney	
Helen Clark Bell	
John Silvester	
Michaela Lutz	
Robbie Cahill	
Emilia Moe	
Jennifer Tunnell	
Emer Bellis	
Stylianos Moschoglou	
Nikhil Chary and Apoorva Kapavarapu	
David Clark-Bell	
Razia Noor-Ketchen	

Condition agreed with the Metropolitan Police

1. A closed-circuit television (CCTV) system shall be installed at the premises. The CCTV system installed at the premises shall be maintained in effective working order and shall be in operation at all times the premises is open to the public. All recordings made by the CCTV system shall be retained and stored in a suitable and secure manner for a minimum of 31 days and shall be made available on request to the Metropolitan Police, the Licensing Authority or other Responsible Authorities. At all times the premises is open to the public a minimum of one member of staff on duty will be able to operate the CCTV system.
2. An incident log shall be kept at the premises and made available on request to Metropolitan Police, the Licensing Authority or other Responsible Authorities. It must be completed within 24 hours of the incident and will record the following; All crimes reported to the premises. All complaints received concerning crime and disorder. Any incidents of disorder. Such logs to be kept for a period of 6 months.
3. If a delivery staff member is carrying out their delivery they must wait to collect any orders inside the premises and shall not loiter outside the premises.
4. Clear legible notices are to be displayed at all exits from the premises requesting patrons to respect the needs of local residents and to leave the premises and area quietly.

Application for a premises licence to be granted under the Licensing Act 2003

PLEASE READ THE FOLLOWING INSTRUCTIONS FIRST

Before completing this form please read the guidance notes at the end of the form. If you are completing this form by hand please write legibly in block capitals. In all cases ensure that your answers are inside the boxes and written in black ink. Use additional sheets if necessary.

You may wish to keep a copy of the completed form for your records.

I/We PJ Corp Stores Limited

(Insert name(s) of applicant)

apply for a premises licence under section 17 of the Licensing Act 2003 for the premises described in Part 1 below (the premises) and I/we are making this application to you as the relevant licensing authority in accordance with section 12 of the Licensing Act 2003

Part 1 – Premises details

Postal address of premises or, if none, ordnance survey map reference or description			
Papa John's 413 Durnsford Road Southfields London			
Post town		Postcode	SW19 8EE

Telephone number at premises (if any)	
Non-domestic rateable value of premises	£14,250

Part 2 - Applicant details

Please state whether you are applying for a premises licence as **Please tick as appropriate**

- a) an individual or individuals * please complete section (A)
- b) a person other than an individual *
- i as a limited company/limited liability partnership please complete section (B)
- ii as a partnership (other than limited liability) please complete section (B)
- iii as an unincorporated association or please complete section (B)
- iv other (for example a statutory corporation) please complete section (B)
- c) a recognised club please complete section (B)
- d) a charity please complete section (B)

- e) the proprietor of an educational establishment please complete section (B)
- f) a health service body please complete section (B)
- g) a person who is registered under Part 2 of the Care Standards Act 2000 (c14) in respect of an independent hospital in Wales please complete section (B)
- ga) a person who is registered under Chapter 2 of Part 1 of the Health and Social Care Act 2008 (within the meaning of that Part) in an independent hospital in England please complete section (B)
- h) the chief officer of police of a police force in England and Wales please complete section (B)

* If you are applying as a person described in (a) or (b) please confirm (by ticking yes to one box below):

- I am carrying on or proposing to carry on a business which involves the use of the premises for licensable activities; or
- I am making the application pursuant to a
 - statutory function or
 - a function discharged by virtue of Her Majesty's prerogative

(A) INDIVIDUAL APPLICANTS (fill in as applicable)

Mr <input type="checkbox"/>	Mrs <input type="checkbox"/>	Miss <input type="checkbox"/>	Ms <input type="checkbox"/>	Other Title (for example, Rev)	
Surname			First names		
Date of birth		I am 18 years old or over <input type="checkbox"/> Please tick yes			
Nationality					
Current residential address if different from premises address					
Post town				Postcode	
Daytime contact telephone number					
E-mail address (optional)					
Where applicable (if demonstrating a right to work via the Home Office online right to work checking service), the 9-digit 'share code' provided to the applicant by that service (please see note 15 for information)					

SECOND INDIVIDUAL APPLICANT (if applicable)

Mr <input type="checkbox"/>	Mrs <input type="checkbox"/>	Miss <input type="checkbox"/>	Ms <input type="checkbox"/>	Other Title (for example, Rev)	
Surname			First names		
Date of birth		I am 18 years old or over		<input type="checkbox"/>	Please tick yes
Nationality					
Where applicable (if demonstrating a right to work via the Home Office online right to work checking service), the 9-digit 'share code' provided to the applicant by that service: (please see note 15 for information)					
Current residential address if different from premises address					
Post town				Postcode	
Daytime contact telephone number					
E-mail address (optional)					

(B) OTHER APPLICANTS

Please provide name and registered address of applicant in full. Where appropriate please give any registered number. In the case of a partnership or other joint venture (other than a body corporate), please give the name and address of each party concerned.

Name
PJ Corp Stores Limited
Address
Papa John's International Hub 11 Northfield Drive Northfield Milton Keynes
MK15 0DQ
Registered number (where applicable)
14717771

Description of applicant (for example, partnership, company, unincorporated association etc.) Limited Company
Telephone number (if any)
E-mail address (optional)

Part 3 Operating Schedule

When do you want the premises licence to start?

DD	MM	YYYY
A	S	A P

If you wish the licence to be valid only for a limited period, when do you want it to end?

DD	MM	YYYY

<p>Please give a general description of the premises (please read guidance note 1)</p> <p>Fast food store with delivery service.</p>
--

If 5,000 or more people are expected to attend the premises at any one time, please state the number expected to attend.

--

What licensable activities do you intend to carry on from the premises?

(please see sections 1 and 14 and Schedules 1 and 2 to the Licensing Act 2003)

Provision of regulated entertainment (please read guidance note 2)

Please tick all that apply

- a) plays (if ticking yes, fill in box A)
- b) films (if ticking yes, fill in box B)
- c) indoor sporting events (if ticking yes, fill in box C)
- d) boxing or wrestling entertainment (if ticking yes, fill in box D)
- e) live music (if ticking yes, fill in box E)

- f) recorded music (if ticking yes, fill in box F)
- g) performances of dance (if ticking yes, fill in box G)
- h) anything of a similar description to that falling within (e), (f) or (g)
(if ticking yes, fill in box H)

Provision of late night refreshment (if ticking yes, fill in box I)

Supply of alcohol (if ticking yes, fill in box J)

In all cases complete boxes K, L and M

A

Plays Standard days and timings (please read guidance note 7)			<u>Will the performance of a play take place indoors or outdoors or both – please tick</u> (please read guidance note 3)	Indoors	<input type="checkbox"/>
				Outdoors	<input type="checkbox"/>
				Both	<input type="checkbox"/>
Day	Start	Finish			
Mon			<u>Please give further details here</u> (please read guidance note 4)		
Tue					
Wed			<u>State any seasonal variations for performing plays</u> (please read guidance note 5)		
Thur					
Fri			<u>Non standard timings. Where you intend to use the premises for the performance of plays at different times to those listed in the column on the left, please list</u> (please read guidance note 6)		
Sat					
Sun					

B

Films Standard days and timings (please read guidance note 7)			<u>Will the exhibition of films take place indoors or outdoors or both – please tick</u> (please read guidance note 3)	Indoors	<input type="checkbox"/>
				Outdoors	<input type="checkbox"/>
				Both	<input type="checkbox"/>
Day	Start	Finish	<u>Please give further details here</u> (please read guidance note 4)		
Mon					
Tue					
Wed					
Thur					
Fri					
Sat					
Sun					
			<u>State any seasonal variations for the exhibition of films</u> (please read guidance note 5)		
			<u>Non standard timings. Where you intend to use the premises for the exhibition of films at different times to those listed in the column on the left, please list</u> (please read guidance note 6)		

C

Indoor sporting events Standard days and timings (please read guidance note 7)			<u>Please give further details</u> (please read guidance note 4)
Day	Start	Finish	
Mon			<u>State any seasonal variations for indoor sporting events</u> (please read guidance note 5)
Tue			
Wed			
Thur			<u>Non standard timings. Where you intend to use the premises for indoor sporting events at different times to those listed in the column on the left, please list</u> (please read guidance note 6)
Fri			
Sat			
Sun			

D

Boxing or wrestling entertainments Standard days and timings (please read guidance note 7)			<u>Will the boxing or wrestling entertainment take place indoors or outdoors or both – please tick</u> (please read guidance note 3)	Indoors	<input type="checkbox"/>
				Outdoors	<input type="checkbox"/>
				Both	<input type="checkbox"/>
Day	Start	Finish			
Mon			<u>Please give further details here</u> (please read guidance note 4)		
Tue					
Wed			<u>State any seasonal variations for boxing or wrestling entertainment</u> (please read guidance note 5)		
Thur					
Fri			<u>Non standard timings. Where you intend to use the premises for boxing or wrestling entertainment at different times to those listed in the column on the left, please list</u> (please read guidance note 6)		
Sat					
Sun					

E

Live music Standard days and timings (please read guidance note 7)			<u>Will the performance of live music take place indoors or outdoors or both – please tick</u> (please read guidance note 3)	Indoors	<input type="checkbox"/>
				Outdoors	<input type="checkbox"/>
				Both	<input type="checkbox"/>
Day	Start	Finish	<u>Please give further details here</u> (please read guidance note 4)		
Mon					
Tue					
Wed					
Thur					
Fri					
Sat					
Sun					
			<u>State any seasonal variations for the performance of live music</u> (please read guidance note 5)		
			<u>Non standard timings. Where you intend to use the premises for the performance of live music at different times to those listed in the column on the left, please list</u> (please read guidance note 6)		

F

Recorded music Standard days and timings (please read guidance note 7)			<u>Will the playing of recorded music take place indoors or outdoors or both – please tick</u> (please read guidance note 3)	Indoors	<input type="checkbox"/>
				Outdoors	<input type="checkbox"/>
				Both	<input type="checkbox"/>
Day	Start	Finish	<u>Please give further details here</u> (please read guidance note 4)		
Mon					
Tue			<u>State any seasonal variations for the playing of recorded music</u> (please read guidance note 5)		
Wed					
Thur			<u>Non standard timings. Where you intend to use the premises for the playing of recorded music at different times to those listed in the column on the left, please list</u> (please read guidance note 6)		
Fri					
Sat					
Sun					

G

Performances of dance Standard days and timings (please read guidance note 7)			<u>Will the performance of dance take place indoors or outdoors or both – please tick</u> (please read guidance note 3)	Indoors	<input type="checkbox"/>			
				Outdoors	<input type="checkbox"/>			
				Both	<input type="checkbox"/>			
Day	Start	Finish	<u>Please give further details here</u> (please read guidance note 4)					
Mon								
Tue								
Wed						<u>State any seasonal variations for the performance of dance</u> (please read guidance note 5)		
Thur								
Fri						<u>Non standard timings. Where you intend to use the premises for the performance of dance at different times to those listed in the column on the left, please list</u> (please read guidance note 6)		
Sat								
Sun								

H

Anything of a similar description to that falling within (e), (f) or (g) Standard days and timings (please read guidance note 7)			Please give a description of the type of entertainment you will be providing		
Day	Start	Finish	<u>Will this entertainment take place indoors or outdoors or both – please tick</u> (please read guidance note 3)	Indoors	<input type="checkbox"/>
Mon				Outdoors	<input type="checkbox"/>
				Both	<input type="checkbox"/>
Tue			<u>Please give further details here</u> (please read guidance note 4)		
Wed					
Thur			<u>State any seasonal variations for entertainment of a similar description to that falling within (e), (f) or (g)</u> (please read guidance note 5)		
Fri					
Sat			<u>Non standard timings. Where you intend to use the premises for the entertainment of a similar description to that falling within (e), (f) or (g) at different times to those listed in the column on the left, please list</u> (please read guidance note 6)		
Sun					

I

Late night refreshment Standard days and timings (please read guidance note 7)			Will the provision of late night refreshment take place indoors or outdoors or both – please tick (please read guidance note 3)	Indoors	<input type="checkbox"/>
				Outdoors	<input type="checkbox"/>
				Both	<input checked="" type="checkbox"/>
Day	Start	Finish			
Mon	23:00	05:00	<u>Please give further details here</u> (please read guidance note 4)		
Tue	23:00	05:00			
Wed	23:00	05:00	<u>State any seasonal variations for the provision of late night refreshment</u> (please read guidance note 5)		
Thur	23:00	05:00			
Fri	23:00	05:00	<u>Non standard timings. Where you intend to use the premises for the provision of late night refreshment at different times, to those listed in the column on the left, please list</u> (please read guidance note 6) If applicable, an additional hour to the standard and non-standard times on the day when British summertime commences. From the standard start timing on 31 st December to the standard start time on the 1 st January.		
Sat	23:00	05:00			
Sun	23:00	05:00			

J

Supply of alcohol Standard days and timings (please read guidance note 7)			<u>Will the supply of alcohol be for consumption – please tick</u> (please read guidance note 8)	On the premises	<input type="checkbox"/>
				Off the premises	<input type="checkbox"/>
				Both	<input type="checkbox"/>
Day	Start	Finish	<u>State any seasonal variations for the supply of alcohol</u> (please read guidance note 5)		
Mon					
Tue					
Wed					
Thur					
Fri					
Sat					
Sun			<u>Non standard timings. Where you intend to use the premises for the supply of alcohol at different times to those listed in the column on the left, please list</u> (please read guidance note 6)		

State the name and details of the individual whom you wish to specify on the licence as designated premises supervisor (Please see declaration about the entitlement to work in the checklist at the end of the form):

Name	
Date of birth	
Address	
Postcode	
Personal licence number (if known)	
Issuing licensing authority (if known)	

K

Please highlight any adult entertainment or services, activities, other entertainment or matters ancillary to the use of the premises that may give rise to concern in respect of children (please read guidance note 9).

As far as the applicant is aware none of the proposed activities should give rise to concern in respect of children.

L

Hours premises are open to the public Standard days and timings (please read guidance note 7)			<u>State any seasonal variations</u> (please read guidance note 5)
Day	Start	Finish	<u>Non standard timings. Where you intend the premises to be open to the public at different times from those listed in the column on the left, please list</u> (please read guidance note 6) If applicable, an additional hour to the standard and non-standard times on the day when British summertime commences. From the standard start timing on 31 st December to the standard start time on the 1 st January.
Mon	00:00	24:00	
Tue	00:00	24:00	
Wed	00:00	24:00	
Thur	00:00	24:00	
Fri	00:00	24:00	
Sat	00:00	24:00	
Sun	00:00	24:00	

M

Describe the steps you intend to take to promote the four licensing objectives:

a) General – all four licensing objectives (b, c, d and e) (please read guidance note 10)

The licensing objectives have been considered taking into account the nature of the premises and the proposed style of operation.

The premises will operate in accordance with all relevant legislation.

The premises will liaise and co-cooperate with the Responsible Authorities.

The premises shall close to the public after 02:00 and will then operate solely as a delivery service until 05:00.

b) The prevention of crime and disorder

A CCTV system with recording equipment must be installed and maintained at the premises.

All recordings used in conjunction with CCTV must:

- Be of evidential quality in all lighting conditions;
- Indicate the correct time and date; and
- Be retained for a period of 31 consecutive days.

An incident/accident book or electronic record must be kept to record all instances of disorder, damage to property and personal injury at the premises. Such records must be made available for inspection and copying by the Police and other officers of Responsible Authorities. Records are to be retained at the premises for at least 6 months.

c) Public safety

The premises will operate in accordance with all relevant legislation which promotes the prevention of public safety objective. For example, the Health & Safety and Food Safety legislation

The premises will liaise and co-operate with the Responsible Authorities.

d) The prevention of public nuisance

The premises will operate in accordance with all relevant legislation which promotes the prevention of public nuisance objective. For example, Environmental Protection Act 1990.

Arrangements for the storage and disposal of refuse will not cause a nuisance.

The premises will liaise and co-operate with the Responsible Authorities.

e) The protection of children from harm

See box a) above.

Checklist:

Please tick to indicate agreement

- I have made or enclosed payment of the fee.
- I have enclosed the plan of the premises.
- I have sent copies of this application and the plan to responsible authorities and others where applicable.
- I have enclosed the consent form completed by the individual I wish to be designated premises supervisor, if applicable.
- I understand that I must now advertise my application.
- I understand that if I do not comply with the above requirements my application will be rejected.
- [Applicable to all individual applicants, including those in a partnership which is not a limited liability partnership, but not companies or limited liability partnerships] I have included documents demonstrating my entitlement to work in the United Kingdom or my share code issued by the Home Office online right to work checking service (please read note 15).

IT IS AN OFFENCE, UNDER SECTION 158 OF THE LICENSING ACT 2003, TO MAKE A FALSE STATEMENT IN OR IN CONNECTION WITH THIS APPLICATION. THOSE WHO MAKE A FALSE STATEMENT MAY BE LIABLE ON SUMMARY CONVICTION TO A FINE OF ANY AMOUNT.

IT IS AN OFFENCE UNDER SECTION 24B OF THE IMMIGRATION ACT 1971 FOR A PERSON TO WORK WHEN THEY KNOW, OR HAVE REASONABLE CAUSE TO BELIEVE, THAT THEY ARE DISQUALIFIED FROM DOING SO BY REASON OF THEIR IMMIGRATION STATUS. THOSE WHO EMPLOY AN ADULT WITHOUT LEAVE OR WHO IS SUBJECT TO CONDITIONS AS TO EMPLOYMENT WILL BE LIABLE TO A CIVIL PENALTY UNDER SECTION 15 OF THE IMMIGRATION, ASYLUM AND NATIONALITY ACT 2006 AND PURSUANT TO SECTION 21 OF THE SAME ACT, WILL BE COMMITTING AN OFFENCE WHERE THEY DO SO IN THE KNOWLEDGE, OR WITH REASONABLE CAUSE TO BELIEVE, THAT THE EMPLOYEE IS DISQUALIFIED.

Part 4 – Signatures (please read guidance note 11)

Signature of applicant or applicant’s solicitor or other duly authorised agent (see guidance note 12). **If signing on behalf of the applicant, please state in what capacity.**

Declaration	<ul style="list-style-type: none"> • [Applicable to individual applicants only, including those in a partnership which is not a limited liability partnership] I understand I am not entitled to be issued with a licence if I do not have the entitlement to live and work in the UK (or if I am subject to a condition preventing me from doing work relating to the carrying on of a licensable activity) and that my licence will become invalid if I cease to be entitled to live and work in the UK (please read guidance note 15). • The DPS named in this application form is entitled to work in the UK (and is not subject to conditions preventing him or her from doing work relating to a licensable activity) and I have seen a copy of his or her proof of entitlement to work, or have conducted an online right to work check using the Home Office online right to work checking service which confirmed their right to work (please see note 15)
Signature	<i>Licensing Law Consultancy</i>
Date	29 December 2023
Capacity	Authorised Agent

For joint applications, signature of 2nd applicant or 2nd applicant's solicitor or other authorised agent (please read guidance note 13). **If signing on behalf of the applicant, please state in what capacity.**

Signature	
Date	
Capacity	

Contact name (where not previously given) and postal address for correspondence associated with this application (please read guidance note 14)			
Walaiti Rathore Licensing Law Consultancy 3 The Triangle NG2 Business Park Queens Drive			
Post town	Nottingham	Postcode	NG2 1AE
Telephone number (if any)	0115 784 3822		
If you would prefer us to correspond with you by e-mail, your e-mail address (optional)			
walaiti.rathore@licensinglawconsultancy.co.uk			

Notes for Guidance

1. Describe the premises, for example the type of premises, its general situation and layout and any other information which could be relevant to the licensing objectives. Where your application includes off-supplies of alcohol and you intend to provide a place for consumption of these off-supplies, you must include a description of where the place will be and its proximity to the premises.
2. In terms of specific regulated entertainments please note that:
 - Plays: no licence is required for performances between 08:00 and 23.00 on any day, provided that the audience does not exceed 500.
 - Films: no licence is required for 'not-for-profit' film exhibition held in community premises between 08.00 and 23.00 on any day provided that the audience does not exceed 500 and the organiser (a) gets consent to the screening from a person who is responsible for the premises; and (b) ensures that each such screening abides by age classification ratings.
 - Indoor sporting events: no licence is required for performances between 08.00 and 23.00 on any day, provided that the audience does not exceed 1000.
 - Boxing or Wrestling Entertainment: no licence is required for a contest, exhibition or display of Greco-Roman wrestling, or freestyle wrestling between 08.00 and 23.00 on any day, provided that the audience does not exceed 1000. Combined fighting sports – defined as a contest, exhibition or display which combines boxing or wrestling with one or more martial arts – are licensable as a boxing or wrestling entertainment rather than an indoor sporting event.
 - Live music: no licence permission is required for:
 - a performance of unamplified live music between 08.00 and 23.00 on any day, on any premises.
 - a performance of amplified live music between 08.00 and 23.00 on any day on premises authorised to sell alcohol for consumption on those premises, provided that the audience does not exceed 500.
 - a performance of amplified live music between 08.00 and 23.00 on any day, in a workplace that is not licensed to sell alcohol on those premises, provided that the audience does not exceed 500.
 - a performance of amplified live music between 08.00 and 23.00 on any day, in a church hall, village hall, community hall, or other similar community premises, that is not licensed by a premises licence to sell alcohol, provided that (a) the audience does not exceed 500, and (b) the organiser gets consent for the performance from a person who is responsible for the premises.
 - a performance of amplified live music between 08.00 and 23.00 on any day, at the non-residential premises of (i) a local authority, or (ii) a school, or (iii) a hospital, provided that (a) the audience does not exceed

500, and (b) the organiser gets consent for the performance on the relevant premises from: (i) the local authority concerned, or (ii) the school or (iii) the health care provider for the hospital.

- Recorded Music: no licence permission is required for:
 - any playing of recorded music between 08.00 and 23.00 on any day on premises authorised to sell alcohol for consumption on those premises, provided that the audience does not exceed 500.
 - any playing of recorded music between 08.00 and 23.00 on any day, in a church hall, village hall, community hall, or other similar community premises, that is not licensed by a premises licence to sell alcohol, provided that (a) the audience does not exceed 500, and (b) the organiser gets consent for the performance from a person who is responsible for the premises.
 - any playing of recorded music between 08.00 and 23.00 on any day, at the non-residential premises of (i) a local authority, or (ii) a school, or (iii) a hospital, provided that (a) the audience does not exceed 500, and (b) the organiser gets consent for the performance on the relevant premises from: (i) the local authority concerned, or (ii) the school proprietor or (iii) the health care provider for the hospital.
 - Dance: no licence is required for performances between 08.00 and 23.00 on any day, provided that the audience does not exceed 500. However, a performance which amounts to adult entertainment remains licensable.
 - Cross activity exemptions: no licence is required between 08.00 and 23.00 on any day, with no limit on audience size for:
 - any entertainment taking place on the premises of the local authority where the entertainment is provided by or on behalf of the local authority;
 - any entertainment taking place on the hospital premises of the health care provider where the entertainment is provided by or on behalf of the health care provider;
 - any entertainment taking place on the premises of the school where the entertainment is provided by or on behalf of the school proprietor; and
 - any entertainment (excluding films and a boxing or wrestling entertainment) taking place at a travelling circus, provided that (a) it takes place within a moveable structure that accommodates the audience, and (b) that the travelling circus has not been located on the same site for more than 28 consecutive days.
3. Where taking place in a building or other structure please tick as appropriate (indoors may include a tent).
 4. For example the type of activity to be authorised, if not already stated, and give relevant further details, for example (but not exclusively) whether or not music will be amplified or unamplified.
 5. For example (but not exclusively), where the activity will occur on additional days during the summer months.
 6. For example (but not exclusively), where you wish the activity to go on longer on a particular day e.g. Christmas Eve.
 7. Please give timings in 24 hour clock (e.g. 16.00) and only give details for the days of the week when you intend the premises to be used for the activity.
 8. If you wish people to be able to consume alcohol on the premises, please tick 'on the premises'. If you wish people to be able to purchase alcohol to consume away from the premises, please tick 'off the premises'. If you wish people to be able to do both, please tick 'both'.
 9. Please give information about anything intended to occur at the premises or ancillary to the use of the premises which may give rise to concern in respect of children, regardless of whether you intend children to have access to the premises, for example (but not exclusively) nudity or semi-nudity, films for restricted age groups or the presence of gaming machines.

10. Please list here steps you will take to promote all four licensing objectives together.
11. The application form must be signed.
12. An applicant's agent (for example solicitor) may sign the form on their behalf provided that they have actual authority to do so.
13. Where there is more than one applicant, each of the applicants or their respective agent must sign the application form.
14. This is the address which we shall use to correspond with you about this application.

15. Entitlement to work/immigration status for individual applicants and applications from partnerships which are not limited liability partnerships:

A licence may not be held by an individual or an individual in a partnership who is resident in the UK who:

- does not have the right to live and work in the UK; or
- is subject to a condition preventing him or her from doing work relating to the carrying on of a licensable activity.

Any premises licence issued in respect of an application made on or after 6 April 2017 will become invalid if the holder ceases to be entitled to work in the UK.

Applicants must demonstrate that they have an entitlement to work in the UK and are not subject to a condition preventing them from doing work relating to the carrying on of a licensable activity. They do this in one of two ways: 1) by providing with this application copies or scanned copies of the documents listed below (which do not need to be certified), or 2) by providing their 'share code' to enable the licensing authority to carry out a check using the Home Office online right to work checking service (see below).

Documents which demonstrate entitlement to work in the UK

- An expired or current passport showing the holder, or a person named in the passport as the child of the holder, is a British citizen or a citizen of the UK and Colonies having the right of abode in the UK [please see note below about which sections of the passport to copy].
- An expired or current passport or national identity card showing the holder, or a person named in the passport as the child of the holder, is a national of a European Economic Area country or Switzerland.
- A Registration Certificate or document certifying permanent residence issued by the Home Office to a national of a European Economic Area country or Switzerland.
- A Permanent Residence Card issued by the Home Office to the family member of a national of a European Economic Area country or Switzerland.
- A **current** Biometric Immigration Document (Biometric Residence Permit) issued by the Home Office to the holder indicating that the person named is allowed to stay indefinitely in the UK, or has no time limit on their stay in the UK.
- A **current** passport endorsed to show that the holder is exempt from immigration control, is allowed to stay indefinitely in the UK, has the right of abode in the UK, or has no time limit on their stay in the UK.
- A **current** Immigration Status Document issued by the Home Office to the holder with an endorsement indicating that the named person is allowed to stay indefinitely

in the UK or has no time limit on their stay in the UK, **when produced in combination with** an official document giving the person's permanent National Insurance number and their name issued by a Government agency or a previous employer.

- A birth or adoption certificate issued in the UK, **when produced in combination with** an official document giving the person's permanent National Insurance number and their name issued by a Government agency or a previous employer.
- A birth or adoption certificate issued in the Channel Islands, the Isle of Man or Ireland **when produced in combination with** an official document giving the person's permanent National Insurance number and their name issued by a Government agency or a previous employer.
- A certificate of registration or naturalisation as a British citizen, **when produced in combination with** an official document giving the person's permanent National Insurance number and their name issued by a Government agency or a previous employer.
- A **current** passport endorsed to show that the holder is allowed to stay in the UK and is currently allowed to work and is not subject to a condition preventing the holder from doing work relating to the carrying on of a licensable activity.
- A **current** Biometric Immigration Document (Biometric Residence Permit) issued by the Home Office to the holder which indicates that the named person can currently stay in the UK and is allowed to work relation to the carrying on of a licensable activity.
- A **current** Residence Card issued by the Home Office to a person who is not a national of a European Economic Area state or Switzerland but who is a family member of such a national or who has derivative rights of residence.
- A **current** Immigration Status Document containing a photograph issued by the Home Office to the holder with an endorsement indicating that the named person may stay in the UK, and is allowed to work and is not subject to a condition preventing the holder from doing work relating to the carrying on of a licensable activity **when produced in combination with** an official document giving the person's permanent National Insurance number and their name issued by a Government agency or a previous employer.
- A Certificate of Application, **less than 6 months old**, issued by the Home Office under regulation 18(3) or 20(2) of the Immigration (European Economic Area) Regulations 2016, to a person who is not a national of a European Economic Area state or Switzerland but who is a family member of such a national or who has derivative rights of residence.
- Reasonable evidence that the person has an outstanding application to vary their permission to be in the UK with the Home Office such as the Home Office acknowledgement letter or proof of postage evidence, or reasonable evidence that the

person has an appeal or administrative review pending on an immigration decision, such as an appeal or administrative review reference number.

- Reasonable evidence that a person who is not a national of a European Economic Area state or Switzerland but who is a family member of such a national or who has derivative rights of residence in exercising treaty rights in the UK including:
 - evidence of the applicant's own identity – such as a passport,
 - evidence of their relationship with the European Economic Area family member – e.g. a marriage certificate, civil partnership certificate or birth certificate, and
 - evidence that the European Economic Area national has a right of permanent residence in the UK or is one of the following if they have been in the UK for more than 3 months:
 - (i) working e.g. employment contract, wage slips, letter from the employer,
 - (ii) self-employed e.g. contracts, invoices, or audited accounts with a bank,
 - (iii) studying e.g. letter from the school, college or university and evidence of sufficient funds; or
 - (iv) self-sufficient e.g. bank statements.

Family members of European Economic Area nationals who are studying or financially independent must also provide evidence that the European Economic Area national and any family members hold comprehensive sickness insurance in the UK. This can include a private medical insurance policy, an EHIC card or an S1, S2 or S3 form.

Original documents must not be sent to licensing authorities. If the document copied is a passport, a copy of the following pages should be provided:

- (i) any page containing the holder's personal details including nationality;
- (ii) any page containing the holder's photograph;
- (iii) any page containing the holder's signature;
- (iv) any page containing the date of expiry; and
- (v) any page containing information indicating the holder has permission to enter or remain in the UK and is permitted to work.

If the document is not a passport, a copy of the whole document should be provided.

Your right to work will be checked as part of your licensing application and this could involve us checking your immigration status with the Home Office. We may otherwise share information with the Home Office. Your licence application will not be determined until you have complied with this guidance.

Home Office online right to work checking service

As an alternative to providing a copy of the documents listed above, applicants may demonstrate their right to work by allowing the licensing authority to carry out a check with the Home Office online right to work checking service.

To demonstrate their right to work via the Home Office online right to work checking service, applicants should include in this application their 9-digit share code (provided to them upon accessing the service at <https://www.gov.uk/prove-right-to-work>) which, along with the applicant's date of birth (provided within this application), will allow the licensing authority to carry out the check.

In order to establish the applicant's right to work, the check will need to indicate that the applicant is allowed to work in the United Kingdom and is not subject to a condition preventing them from doing work relating to the carrying on of a licensable activity.

An online check will not be possible in all circumstances because not all applicants will have an immigration status that can be checked online. The Home Office online right to work checking service sets out what information and/or documentation applicants will need in order to access the service. Applicants who are unable to obtain a share code from the service should submit copy documents as set out above.

Yard

PROPOSED AIR EXTRACT DUCT WITH BRICK EFFECT CLADDING VENTED 1000mm ABOVE SECOND FLOOR EAVES LEVEL 450x450mm WITH INLINE FAN LOCATED INTERNALLY.

PROPOSED FRESH AIR INTAKE GRILLE TO KITCHEN

Page 30

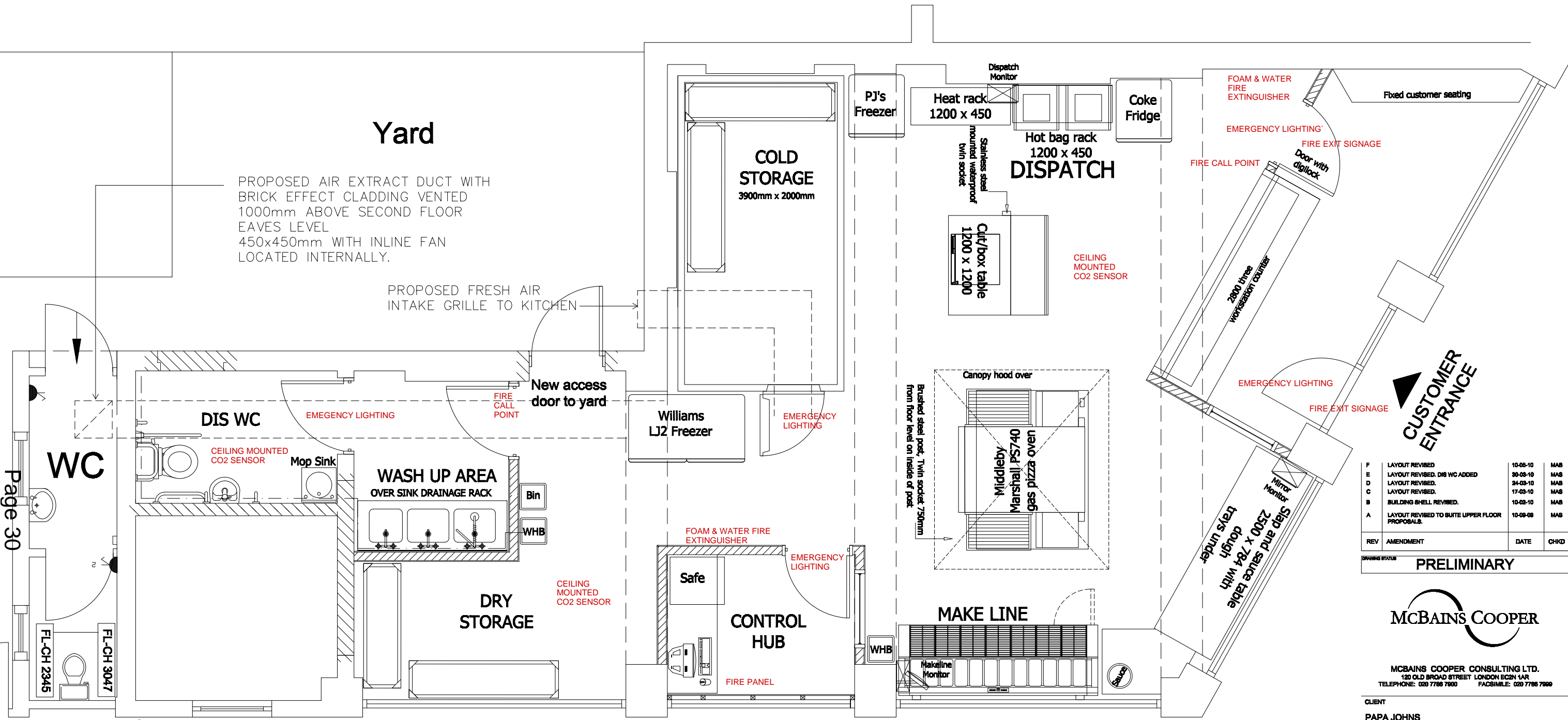

REV	AMENDMENT	DATE	CHKD
F	LAYOUT REVISED	10-08-10	MAS
E	LAYOUT REVISED. DIS WC ADDED	30-09-10	MAS
D	LAYOUT REVISED.	24-09-10	MAS
C	LAYOUT REVISED.	17-09-10	MAS
B	BUILDING SHELL REVISED.	10-02-10	MAS
A	LAYOUT REVISED TO SUITE UPPER FLOOR PROPOSAL.	10-09-09	MAS

DRAWING STATUS: **PRELIMINARY**

MCBAINS COOPER

MCBAINS COOPER CONSULTING LTD.
120 OLD BROAD STREET LONDON EC2N 1AR
TELEPHONE: 020 7786 7900 FACSIMILE: 020 7786 7909

CLIENT
PAPA JOHNS

PROJECT
**413 DURNSFORD ROAD
LONDON, SW19 8EE**

DRAWING TITLE
**GROUND FLOOR
PROPOSED LAYOUT**

BUILDING SURVEYING

SCALE	DRAWN BY	CHECKED	DATE
1:50@ A3	JW		AUG 09
DRAWING NUMBER BBSPJSW19/P/01			REVISION F



Agreed Amendments to LNR/Opening hours to the Public and additional Police conditions.

Papa Johns 413 Durnsford Road Southfields SW19 8EE.

Late Night Refreshment

Monday to Sunday 23:00 to 02:00

Hours open to the public

Monday to Sunday 11:00 to 00:00

Deliveries only

00:00 hours till 02:00

CCTV

A closed-circuit television (CCTV) system shall be installed at the premises. The CCTV system installed at the premises shall be maintained in effective working order and shall be in operation at all times the premises is open to the public. All recordings made by the CCTV system shall be retained and stored in a suitable and secure manner for a minimum of 31 days and shall be made available on request to the Metropolitan Police, the Licensing Authority or other Responsible Authorities. At all times the premises is open to the public a minimum of one member of staff on duty will be able to operate the CCTV system.

Security incidents logs.

An incident log shall be kept at the premises and made available on request to Metropolitan Police, the Licensing Authority or other Responsible Authorities. It must be completed within 24 hours of the incident and will record the following; All crimes reported to the premises. All complaints received concerning crime and disorder. Any incidents of disorder. Such logs to be kept for a period of 6 months.

Deliveries

If a delivery staff member is carrying out their delivery they must wait to collect any orders inside the premises and shall not loiter outside the premises.

Conduct of premises

Clear legible notices are to be displayed at all exits from the premises requesting patrons to respect the needs of local residents and to leave the premises and area quietly.

Dear Merton Council,

I am a resident of Mount Road, 30 second walk to Papa John on 413 Dunsford Road, Wimbledon Park, SW19 8EE.

I am writing to express my concern about their request to extend their opening hours until 5am. Our street and the surrounding area are already quite noisy at night with drunk/anti social behaviours.

I feel unsafe when I am coming home after 10 pm. I often sense illegal drugs and alcohol consumption amongst the loud group of people in the street.

I fear that Papa John's requested opening hours could trigger, encourage and bring in further anti social behaviors into our neighbourhood.

Please help us keep our children safe, and protect our neighbourhood by not allowing Papa John to be opened until 5am.

Your kind consideration is greatly appreciated.

Warm regards,

Mamiko Hogwood

To whom it may concern,

I am writing to formally express my objection to the current application submitted by Papa John's Pizza seeking a new premise license for their establishment at 413 Dunsford Road. As a resident deeply invested in our community, I am concerned that the proposed extension of operating hours may contribute to public nuisance and exacerbate issues related to crime and disorder.

My objections can be summarized as follows:

1. Noise Pollution and Disturbances:
 - Current disturbances, such as the noise of motorbike engines and improper disposal of rubbish, are already affecting the neighborhood.
 - Extended operating hours may intensify noise pollution, leading to disturbances late into the night.

2. Public Safety Concerns:

- The location of the premises at the summit of our residential road, where families with young children reside, raises significant public safety concerns.
- The proposed extended hours may compromise the tranquility and safety of our neighborhood.

3. Antisocial Behavior:

- A persistent and noticeable odor of cannabis from the premises and surroundings has been observed at various times throughout the day.
- Existing issues with antisocial behavior may worsen with late-night operations, impacting the safety and well-being of the community.

4. Potential for Criminal Activity:

- Concerns that late opening hours could attract additional instances of antisocial and criminal activities, posing further risks to the community.

In light of these concerns, I strongly implore the licensing authority to decline the application to ensure the protection of our neighborhood's peace and security.

I appreciate your consideration of these issues and trust that you will give due regard to the well-founded objections raised by the local residents in your decision-making process.

Thank you for your attention to this matter.

Sincerely,
Stanislas Hembise

To whom it may concern,

I would like to object to the new premises license that has been applied for by PJ Corp Stores Ltd with respect to Papa Johns 413 Durnsford Road.

My objection relates to the extended opening hours that have been requested past midnight to 5 a.m. The adjacent road which I live on is already plagued by multiple delivery drivers travelling at speed and creating noise past reasonable hours. This extension of opening hours would only increase that noise pollution while also increasing the potential for anti-social behaviour and disturbances.

As the local area is full of families with young children, the granting of such a license would negatively impact the local community by allowing for late night noise and anti-social behaviour overnight.

I urge you to consider the well being of the local residents and their families by denying this application.

Yours sincerely,

Viren Patel

I would like to object to the current application put forward by Papa John's Pizza on 413 Durnsford Road for a new premise license.

I am a local resident and I am concerned that the proposed late opening hours would likely lead to public nuisance (Prevention of public nuisance) and potentially also to crime and disorder (Prevention of crime and disorder).

Specifically, I am concerned about a worsening in noise pollution, disturbances and antisocial behaviour. We already experience some noise disturbance and incidents of motorbikes revving their engines in the vicinity of the establishment. Furthermore, there is a problem with empty bottles being discarded onto the pavement at the top of Mount Road. Many of the local residents, myself included, have also observed that there is strong smell of cannabis emanating from the premises and immediate vicinity, frequently and at different times of the day.

As you can imagine, this is already a nuisance and a public safety concern as the premises are at the top of our residential road, and myself and many of my neighbours have young children. These issues are having a detrimental impact on our local community.

We anticipate that with extended opening hours these problems will be made worse and lead to disturbances into the small hours. I also worry that late opening would attract further antisocial and potentially criminal activity.

For these reasons I would strongly urge you to deny this application.

Yours sincerely,
Roland Seregi

To whom it may concern,

Ref: Licensing application WK/202410230

I am writing to share my concerns with above the licensing application made by PJ Corp Stores Limited for the 413 Durnsford Road branch of Papa Johns to remain open to the public until 02:00, and then for delivery until 05:00.

I am a local resident and I do not believe that the applicant meets any of the four licensing objectives, as outlined below:

1. Prevention of crime and disorder

The premises is located in a primarily residential location. By extending its opening hours, it will become a 'hub' for groups to congregate late at night, increasing noise disorder and crime. This will very likely bring with it the associated violence and drug use that similar late night venues suffer from. Myself and a number of other local residents have already observed the smell of cannabis emanating from its immediate vicinity and have witnessed confrontations between groups of males as they arrive and depart under the current licencing arrangement.

Moreover, foot traffic to and from the premises is through residential streets and undertaken by revellers who show little regard for the impact noisy conversations have on sleeping residents. This is already a challenge faced by local residents and one which will only be exacerbated by extending opening hours.

While the applicant has suggested the installation of CCTV cameras, this will do little to deter any of the above from taking place.

2. Public safety

The premises is located on a busy main road that does not have adequate parking for patrons or delivery drivers. As a result, vehicles collecting orders currently mount the pavement of the surrounding residential roads, particularly the adjoining Mount Road. During daylight hours, this causes a risk to public safety, particularly given the number of local residents with young children and push chairs.

It is much more dangerous at night as the area is relatively poorly lit, and hence extending the opening hours of the premises into the night increases this risk to public safety.

3. Prevention of public nuisance

In addition to the concerns raised regarding crime and disorder, the premises currently generates a significant amount of refuse. The disposal facilities are not fit for purpose and often result in rubbish strewn across the surrounding residential area following high winds or disturbance from foxes. Indeed, local residents have

taken to organising 'litter picks' in order to address some of the refuse created on our streets. Extending the opening hours will only increase the refuse generated and thus exacerbate challenges with its disposal.

Moreover, I am concerned that granting of a new licence for this premises may set a precedent for other food delivery venues in the local area, multiplying the public nuisance concerns of local residents from a crime, disorder and refuse perspective.

4. Protection of children from harm

Many of the residents surrounding the premises have young children. The premises is also located within 200 meters of Wimbledon Park Primary School. As highlighted above, the premises inadvertently attracts late night anti-social behavior, dangerous parking, excessive refuse and even drugs to the area at the current time.

With an increase in opening hours comes an increase in the risk of harm each of these brings to children and the applicant has provided little or no little as to how they would look to combat any or all of these risks.

For these reasons, I strongly urge that you deny this application.

Regards,

Nick Tunnell

To whom it may concern

I would like to object to the current application put forward by Papa John's Pizza on 413 Durnsford Road for a new premise license.

I am a local resident and I am concerned that the proposed late opening hours would likely lead to public nuisance (Prevention of public nuisance) and potentially also to crime and disorder (Prevention of crime and disorder).

Specifically, I am concerned about a worsening in noise pollution, disturbances and antisocial behaviour. We already experience some noise disturbance and incidents of motorbikes revving their engines in the vicinity of the establishment. Furthermore, there is a problem with empty bottles being discarded onto the pavement at the top of Mount Road. Many of the local residents, myself included, have also observed that there is strong smell of cannabis emanating from the premises and immediate vicinity, frequently and at different times of the day.

As you can imagine, this is already a nuisance and a public safety concern as the premises are at the top of our residential road, and myself and many of my neighbours have young children. These issues are having a detrimental impact on our local community.

We anticipate that with extended opening hours these problems will be made worse and lead to disturbances into the small hours. I also worry that late opening would attract further antisocial and potentially criminal activity.

For these reasons I would strongly urge you to deny this application.

Yours sincerely

James Dickerson

To whom it may concern

I would like to object to the application put forward by PJ Stores (Papa John's Pizza) on 413 Durnsford Road for a new premises licence.

I am a local resident living on Mount Road, the Papa John's premises are at the top corner of our residential road where many families with young children live. I am concerned that the proposed late opening hours would likely lead to public nuisance and potentially affect public safety.

Public nuisance

Operating the premises late at night is likely to cause public nuisance which will impact on the local residential area. We already experience a lot of noise pollution within the existing opening hours of Papa John's with motorbike engine revving going on late into the evenings. We also already see a detrimental impact on the neighbourhood with discarded rubbish around the premises. I cannot see how either of these public nuisances would improve with longer opening hours.

Public Safety

I am also concerned about public safety. The drivers who pick-up their deliveries already show little respect for road traffic laws. Riders regularly drive across parts of the pavement outside Papa Johns and pull out erratically onto ongoing traffic. Extending hours will not improve these conditions and may also contribute to an increase of accidents and injuries.

Community Engagement

Since Papa John's last attempt at extending their operating hours in 2020, they have made no discernible attempts to engage with the local community or take on board complaints of the local community. I do not imagine, they will do anything further in this regard if granted a later licence.

Lack of Justification

Finally, I do not understand the purpose of prolonging the hours of these premises and can see no real justification for it. They are not located on a busy high street or a commercial zone. This is a very residential area surrounded by a primary school and nurseries. The relevant premises form part of a small row of shops, none of which operate late licensing hours. The premises are not in immediate proximity to any stations and there is thus no obvious footfall that would benefit from access until 2am. The closest pubs on that road, serve food and do not operate extended opening hours. Should customers want to use their delivery services, multiple other Papa John premises already offer late services in the same area within a 10 minute

driving radius. There is, therefore, no discernible benefit to the public or Papa John's customers in being able to order late deliveries from that particular residential branch.

Yours faithfully
Taliah Walklett

To whom it may concern

I wish to register my objection to this application by Papa John's at 413 Durnsford Road for indoor & outdoor refreshments to be extended until 5am, and for the premises to be open 24 hours a day, 7 days a week.

The premises already cause quite a degree of public nuisance and threat to public safety. There are a lot of small motorbikes loitering on the pavement, preventing safe use of the pavement and pulling out without due regard to other users of the roads. Although I have not witnessed any illegal activity there, it is an obvious magnet for the conduct of crime, when so many people wearing helmets congregate...and could for example take delivery of drugs for onward delivery with a pizza as a respectable cover.

Clearly opening 24/7 would be a significant change of noise level for residents in the immediate vicinity.

I therefore object on the grounds of prevention of crime & disorder, public safety, public nuisance and prevention of children from harm.

Yours faithfully
Barbara Walters

Dear Merton Licensing Team,

I am writing to object the recent application ref WK/202410230 from applicant Papa John's of 413 Durnsford Road, London SW19 8EE.

We are objecting the application on all four grounds:

1. prevention of crime and disorder

The late opening proposed by Papa John's will almost certainly attract a different set of clientele which potentially can be exploited by drug dealers. Not to mention, the increase of riders can pose more burglary, bike robbery issues which is already a major problem in the neighbourhood.

2. public safety

Instead of dispersing away from the area, late night takeaways hold people in areas. Alcohol is very easy to get hold of with a few other late licensing premises not far away. This will cause an increase in alcohol related violence and antisocial behaviour. There is not enough security control at the premises to accommodate late openings.

3. prevention of public nuisance

All the increased traffic will cause an increased noise level on Durnsford road and nearby side roads, making it difficult for nearby families to have peace at night. Not to mention, the potential risk of littering and with increased food wastage attracting more pests to the area.

4. protection of children from harm

Further to point 3, our neighbourhood is mostly made up by young families. Increased traffic and noise makes it difficult for babies and children to rest at night, also, the pollution with increased food wastage, traffic gas is not good for the environment.

I sincerely hope you take our concerns into consideration and reject papa John's second attempt at applying for a late night opening.

With regards,
Xinya Guo and Robin Bängs

Dear Sirs,

I am writing to object strongly to the proposed licensing extension by Papa Johns at 413 Durnsford Road, Wimbledon Park, London, SW19 8EE.

We are extremely concerned with the extension to the licensing to 05:00 which brings huge health and safety concerns - increased traffic with increased moped deliveries by drivers often with L plates and little concern to road and pedestrian safety.

We already have complained on numerous occasions about the increased litter due to all the packaging and waste and fear this will only increase.

We are concerned with the potential attraction the late opening will have with criminal activity and drug related issues that often go hand in hand with late night fast food restaurants.

This is a quiet residential area and we do not want late night fast food companies operating into the early hours of the morning causing unnecessary concerns.

Yours faithfully
Edward Gaffney

Dear Licensing

I am writing as a local resident to Papa Johns Pizza at 413 Durnsford Road in relation to their application for a new premises license for extended hours.

Papa Johns is already not a good neighbour to have and I am therefore concerned that the additional proposed late opening hours would likely lead to increased public nuisance (Prevention of public nuisance) and to an increase in crime and disorder (Prevention of crime and disorder) therefore unable to meet two of the Licensing Objectives.

Specifically, I am concerned about a worsening in noise pollution, disturbances and antisocial behaviour. We already experience some noise disturbance and incidents of motorbikes as the delivery platform bikes collect from the premises. Whilst I realise Papa John's does not employ these riders, the very presence and activity of Papa Johns attracts these riders. They regularly have no regard for pedestrians or other vehicles, particularly as they mount the pavement to get to the front door and pull out across the road in an erratic way.

The business does not manage its waste well and have only recently take responsibility for this, coinciding with this planning application! we frequently have to walk past their business waste strewn across the pavement.

The premises are at the end of our residential road that is busy during the day but very quiet at night. There is no other late night license in this area and this should not be used to set a precedent for other businesses to apply in this highly residential area. The vast majority of the businesses in this area close by 6pm, all other businesses close by 11pm including the Sainsbury's Local and other nearby takeaways. Approving this would set a dangerous precedent for our area which may result in a number of late night license applications dramatically changing the nature of the area. This late night license would not be used by the local community but would attract trade from people travelling specifically to this destination and delivery riders only. This is not a town centre, there are other nearby Papa John's in Wimbledon and Putney town centres that can fulfill this need.

At the last late night license application submission which was denied in 2020, Papa Johns was advised to engage with the local community, but we have not seen any such engagement which includes no participation in our street parties and no communication about this licensing application. To give some credit they did convert all their motorbikes to electric bikes but they have now removed all these and are only delivering through external food delivery platforms, meaning they are not in control of the behaviour of these riders.

We anticipate that with extended opening hours these problems will be exacerbated and lead to additional disturbances well into the middle of the night along with further waste issues, increased overnight deliveries whilst attracting further antisocial activity. This location is wrong for this type of license.

For these reasons I would strongly urge you to deny this application.

Yours sincerely
Helen

Helen Clark Bell

I would like to object to the application for later opening times.

I live on Mount Road which is predominately a family area and we are already hounded day and night by traffic who use the road as a rat run!

The area is not a late night location with bars and restaurants, it's an area of residential housing. The increase of deliveries will add to the volume of traffic and noise not only the delivery drivers but also the increase in deliveries of stock for the business to function.

The above business is on a busy junction with Mount rd and Durnsford rd which is already hampered with traffic jams and congestion.

To allow the increase hours would have a dramatic and negative effect on the local community. Not only causing disturbed sleep for adults and children, which will have knock on effects within the work place, family life and school life but also turning a residential area into a commercial hub! We don't want it or need it!

I hope common sense prevails and the application is rejected.

John Silvester

To whom it may concern

I am a local resident and I would like to object to the current application put forward by Papa John's Pizza on 413 Durnsford Road for a new premise license.

Papa John's is applying to extend their opening hours until 5:00am 7 days a week (until 2:00am for walk-in customers and delivery service thereafter). The current opening hours are until 11:00pm 7 days a week.

I am concerned that the proposed late opening hours would lead to public nuisance (Prevention of public nuisance) and potentially also to crime and disorder (Prevention of crime and disorder). This is an exclusively residential neighbourhood which is not served by, and does not support, the kind of establishment Papa John's is planning to set up. I feel very strongly that I do not want a fast food restaurant that is open all hours of the day and night on my doorstep.

Specifically, I am concerned about a worsening in noise pollution, littering, disturbances and antisocial behaviour. We already have experienced noise disturbance in the vicinity of the establishment, as well as littering, with food wrappers and empty bottles being discarded onto the pavement at the top of Mount Road. In the recent past, many local residents, myself included, have noticed a strong smell of cannabis emanating from the premises and immediate vicinity, frequently and at different times of the day.

I am concerned that by extending the opening hours into the early morning, this would invite further disturbance and cause a significant nuisance, compromising the peace and quiet and our quality of life. This is a neighbourhood with many young families and children, and I have two young children myself. I am sure you will agree that a license application of this kind is not appropriate in a highly residential neighbourhood like ours. I therefore urge you to reject this application.

Papa John's has previously applied for a similar license with extended opening hours in 2020, which was strongly objected by the local residents, including myself, and subsequently rejected by the council. As far as I am concerned, nothing has changed, and the same concerns remain regarding the current application. I also worry that if this application is allowed to go ahead, this will set a dangerous precedent for the area, and other establishments will follow suit. This would result in our residential neighbourhood and the character of our local road and surrounding area being permanently changed for the worse.

I appeal for your support in helping the residents of Mount Road and the surrounding area retain the residential character of our neighbourhood.

Yours sincerely
Dr Michaela Lutz

I would like to formally object to the application put forward by Papa John's Pizza on 413 Durnsford Road for a new premise licence. Papa John's is applying to extend their opening hours until 5am 7 days a week (until 2am for walk-in customers and delivery service thereafter). The current opening hours are until 11pm 7 days a week.

I am a local resident and I am concerned that the application would fail to meet all four licensing objectives – prevention of crime and disorder, public safety, prevention of public nuisance, protection of children from harm.

It is important to note here that as the primary school is so close, this area is almost exclusively full of families with young children (I have two myself). It is not a student area or an urban area where nocturnal activity is the norm and therefore it is profoundly anti-social to locate an all-night food vendor in the middle of it. (public nuisance) It should be noted that Papa John's has all night opening hours in nearby town centres of Wimbledon and Putney, these are urban areas where it makes more sense. There is no need to extend this to a local neighbourhood.

It was my belief that local government have been working hard to decrease traffic and its environmental impact in local neighbourhoods but this is one way to ensure it is significantly increased all night long. This will have an environmental impact but of course will cause anti-social noise throughout the night. On top of this, delivery drivers using Papa John's routinely drive their mopeds carelessly over the pavements which is a hazard to say the least, particularly with so many young children around. (public nuisance, protection of children, public safety)

There are already thefts in the area which are very hard to police and this is likely to increase with an increase in activity/footfall all through the night and therefore the risk of crime. It should also be noted that myself and other local residents have noticed a strong smell of cannabis coming from the premises and the vicinity which would no doubt increase if this becomes an all-night establishment. (public safety, prevention of crime)

It should also be noted that whilst the staff and management at this Papa John's branch in question are very friendly, the company do nothing for the community whatsoever aside from cause a trail of litter that blows down the road. No doubt this will increase significantly if this application is granted. (public nuisance)

I am aware that this license was applied for in 2020 and was rejected based on the concerns of local residents. As far as I can tell, nothing has changed.

I strongly urge you protect our local family neighbourhood and reject this completely unnecessary application.

Yours sincerely

Robbie Cahill

To whom it may concern

Re: Objection to 22012024, Papa John's Durnsford road.

This is a very family-centric neighbourhood within minutes of the local school and with a new 'school streets' initiative - a reflection that it is a primarily residential area.

With the rise of deliveries by loud moped drivers, suppliers like Papa Johns increase the road noise and dangerous driving, which is a risk to public safety if located on residential roads. Papa Johns has been given a bad reputation in this area as it has created groups of waiting moped drivers (chatting, smoking, late night noise) not just directly outside it but on neighbouring roads during antisocial hours, which is already a public nuisance. While I personally tolerate this during their current working hours, to seriously consider extending this disruption to 5am every day is preposterous in a residential area.

Looking to the future of food delivery, there are successful similar delivery operations at the Trading Unit 271 Merton Road and at trading units across the UK. Bringing 24-hour trading hours to businesses that spill over onto quiet residential areas such as Mount Road, Acuba Road and Gordondale Road (where the drivers tend to congregate), is something I firmly object to.

This licence request should be denied based on your below objectives:

- prevention of crime and disorder
- public safety
- prevention of public nuisance

Many thanks

E.M.

Emilia Moe

To whom it may concern,

Ref: Licensing application WK/202410230

Please find below my objections regarding the planning application made by PJ Corp Stores Limited for 413 Durnsford Road branch of Papa Johns in regard to extending their opening hour for the public until 2:00 and for delivery drivers until 05:00.

As a local resident I strongly object to the planning application on a number of grounds:

1. Residential area

The site of Papa Johns is in a predominantly residential area. The noise and disruption the extended hours would create are not in keeping of the primary function of the area. Extending opening hours in such a manner would create precedent for

other local eateries to offer the same service and this would have untold impact on those living in close proximity.

2. Noise, light and vehicle pollution

Extending the opening hours of this premise would create unnecessary levels of pollution. The delivery drivers will create a public nuisance with excessive noise pollution from the vehicles collecting deliveries. This will decrease the amenity value of the area and negatively impact the liveability of the area for current residents. Alongside this, extending opening hours will generate excessive vehicle and light pollution, furthermore decreasing the value of the area for those who live there.

3. Risk of antisocial behaviour

There is a risk that these extended hours will attract antisocial behaviour, particularly in regard to people being drunk and disorderly. The site could become a 'hub' for late night activity and therefore encourage groups of people to gather and cause disruption.

4. Excessive waste generation

The current site already creates an excessive amount of litter and waste. This is located at the end of Mount Road, the extended hours will only exacerbate this current issue.

As outlined above I strongly encourage you to deny the application.

Yours sincerely,
Jennifer Tunnell

To Merton Council Licencing Office

I'm writing to notify you of my objections to the application for an extended opening hours licence for Papa John's.

Papa John's is located at the junction of Merton Road and Mount Road, which is a quiet residential street with a lot of young families. There is limited night-time activity in the area, as far as I am aware no other food or entertainment premises that are open into the small hours. Other branches of Papa John's on busier streets in Wimbledon and Putney are open until 1.00 am and 12.00 am respectively.

My personal objection to the extension of opening hours to 2.00 am and delivery hours to 5.00 am is potential noise and sleep disruption. I live at the top of Mount Road, a few doors down from Papa John's, and from the main road. I would not object to an extension of opening hours until midnight.

Thank you for your attention, and I look forward to your reply.

Yours faithfully

Emer Bellis (Mrs)

To Whom It May Concern,

I am writing to formally object to the application submitted by Papa John's Pizza for a new premise license at 413 Durnsford Road and in particular to extend their working hours very late till 5 am. As a resident of Mount Road, I am deeply concerned about the potential negative impact this establishment's proposed late opening hours would have on our community.

My primary concern lies in the likelihood of increased public nuisance stemming from extended operating hours. This includes, but is not limited to, the following:

- Exacerbated noise pollution: We already experience issues with noise disturbances, particularly from motorbikes revving engines near the proposed location. Late-night activity from the pizzeria will likely worsen this problem, significantly impacting the quality of life for nearby residents.
- Increased disorderly conduct: Incidents of antisocial behaviour, such as loud conversations and gatherings, are a potential consequence of extended opening hours. This can create a disruptive and unsafe environment for local residents, especially those with young children.
- Litter and sanitation concerns: Discarded bottles and other waste litter the pavement near the existing location on Mount Road. Late-night operations with potentially increased customers would exacerbate this issue, further impacting both aesthetics and public health.

Furthermore, I raise serious concerns about potential crime and disorder, particularly:

- Antisocial behaviour: The existing issues with motorbike noise and the potential for gatherings near the premises suggest a heightened risk of late-night disturbances and nuisance behaviour.
- Potential for criminal activity: Increased late-night activity in the area could create an environment conducive to crime, raising concerns for the safety of local residents. It is important to emphasize that the proposed location sits at the top of a residential road with a significant number of families residing nearby. The existing issues with noise, litter, and potential drug use, combined with the possibility of increased late-night disturbances and criminal activity, create a significant nuisance and public safety concern for our community.

Therefore, I strongly urge you to deny Papa John's Pizza's application for a new premise license with extended operating hours. The potential negative impact on residents' quality of life, public health, and safety significantly outweighs any perceived benefits of the proposed change.

Thank you for your time and consideration.

Sincerely,

Stylianos Moschoglou

Dear Addressee,

The residents of [redacted] would like to object to the application made by Papa John's Pizza on 413 Durnsford Road SW19 8EE (the Restaurant) for a new premises license which would extend their opening hours up to 5am (7 days a week) (the Application).

The Restaurant operates in a highly residential neighbourhood with several young children, including those who attend Wimbledon Park Primary School. As local residents we are deeply concerned that any extension to the hours of operation of the Restaurant would create a number of unwelcome issues for local residents, including in particular the following:

(A) public nuisance - as Merton Council would be well aware, excessive littering and vandalism inevitably affects the vicinity of any establishment serving fast food late at night. Discarded food packaging and boxes, discarded (and sometimes shattered) glass bottles, and unsanitary habits of inebriated patrons exhibited in streets and pavements near the Restaurant would be extremely unsafe, unpleasant and unhygienic for residents living in the neighbourhood and would overburden the Merton Council with the extra cost and effort to keep such streets and public areas clean and sanitary;

(B) crime and disorder issues - unsocial and inappropriate behaviour (including violence, theft, trespass and other criminal behaviour, consumption of drugs and the use of inappropriate and disrespectful language) is often exhibited by patrons in the vicinity of establishments open late at night, and particularly during late night hours. The occurrence of any such issues in the vicinity of the Restaurant at night would threaten the safety and security of residents, and create noise pollution and other disturbances of the peace. As residents of a quiet and peaceful neighbourhood and as parents of a young child, we are extremely opposed to the creation of any avenues (such as the extension of the Restaurant's operating hours) that could facilitate such behaviour; and

(C) public safety concerns - delivery drivers create numerous safety issues for pedestrians and vehicles including, the improper/erratic use of e-bikes on pavements, the absence or non-use of warning lights and indicators, and a general disregard for road rules. As the Restaurant operates in a highly residential area and a significant percentage of its revenue comes via the use of delivery drivers, the extension of its opening hours to 5am would greatly increase the risk of accidents occurring on the streets and pavements at night time.

While we strongly encourage Merton council to implement efforts to generally improve the quality of the high street on Durnsford Road, granting the Restaurant

permission to operate late at night is counterintuitive to such efforts and would, for the reasons noted above, be greatly detrimental to the neighbourhood within which the Restaurant operates. Accordingly, we strongly urge you to the Application.

We would be happy to make further representations or clarifications to the extent required.

Yours sincerely,

Nikhil Chary and Apoorva Kapavarapu

Dear Licensing Authority,

I am a local resident and I would like to object to the current application put forward by Papa John's Pizza on 413 Durnsford Road for a new premise license.

Papa John's is applying to extend their opening hours until 5:00am 7 days a week (until 2:00am for walk-in customers and delivery service thereafter). The current opening hours are until 11:00pm 7 days a week.

I am writing to express my opposition to the application for a new premise licence by Papa John's Pizza at 413 Durnsford Road. I live in the neighbourhood and I have serious concerns about the negative impact of the proposed late opening hours on the public nuisance (Prevention of public nuisance) and crime and disorder (Prevention of crime and disorder) objectives.

Specifically, I am worried about the increase in noise pollution, disturbances and antisocial behaviour that would result from the extended operation of the business. The area already suffers from some noise nuisance and incidents of motorbikes speeding and revving their engines near the premises. I often find rubbish near Papa John's Pizza and the adjacent parking bays. I have also smelled cannabis from the cars parked there when I walk by Papa John's in the evenings. I have noticed that some people go into Papa Johns and come out without any pizza or purchases, which makes me suspect that there might be other transactions taking place inside the store.

These issues are very troubling and pose a risk to the public safety, especially as the premises are located at the top of our residential road, where many of us have young children. These problems would be exacerbated by the late opening hours, which would cause more noise and disruption into the night. I also fear that late opening would attract more antisocial and potentially criminal activity to the area.

Therefore, I strongly urge you to reject this application for the sake of our local community.

Yours faithfully,
David Clark-Bell

Hi

I am raising an objection to the planning application submitted by PJ Corp to extend trading hours at Papa John at 413 Durnsford Road, Southfields, SE19 8EE.

They are applying to extend walk in opening hours to 2am and further delivery service until 5am, 7 days a week.

This area is a residential area and beside a large primary school.

The area is full of young families.

I live on Mount Road, and our road is plagued with litter and bottles all the way down the street. Extending these opening hours will only increase in the amount of rubbish and pollution we currently experience. It will also encourage rats and mice, of which we already have a problem.

We also experience a lot of pedestrian and vehicle traffic and noise pollution through the day and well into the evening. This noise pollution will now extend into the early hours of the morning. Our residential homes are not built to shut out this volume of noise, which is amplified when it takes place in the early hours.

I am also extremely concerned about the antisocial behaviour increasing on our street. I already smell cannabis on every street in the Wimbledon Park and Southfields area, especially near the flats. I am extremely concerned that the late night food will help to fuel the consumption of drugs in the area. On top of this I constantly hear the shouts and screams of people walking home from the pub, this will only increase if this shop is allowed to remain open into the early hours of the morning.

This residential area is not compatible for a late opening eating establishment. This is not the centre of Wimbledon. Many families will be negatively impacted by the noise and food pollution as well as the increase in drug taking and general anti social behaviour.

I believe there is already a Papa John's in both Wimbledon and Putney who happily service the early morning crowd and are not located in fully residential areas.

I hope that you will continue to support the residents of Mount Road and the surrounding roads by rejecting this application.

Kind regards

Razia Noor-Ketchen (Mrs)